

NOTES:

1. Unless otherwise specified, for part dimensions see model file. General tolerances apply.
2. Material: SAE 303 Free Machining bar/rod per ASTM A582
3. Finish:None

REVISIONS					
ECO	ZONE	REV.	DESCRIPTION	DATE	APPROVED

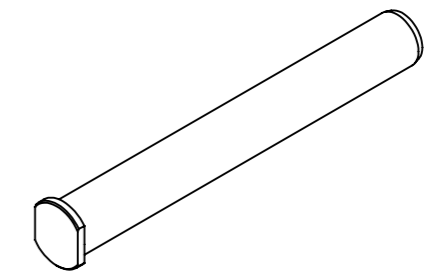
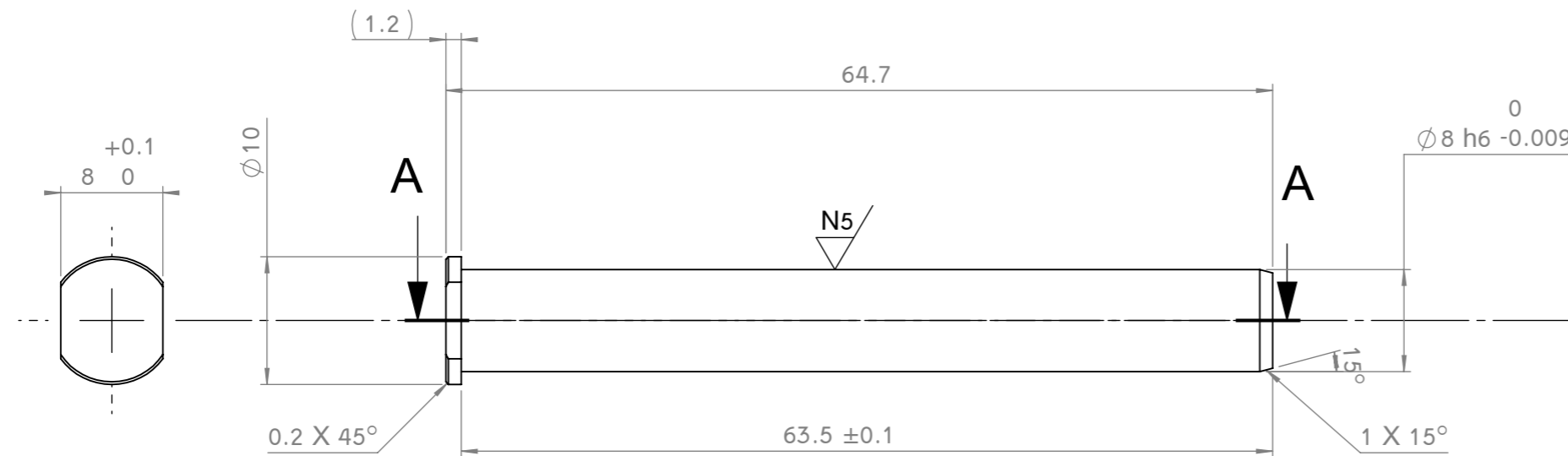

SCALE 1:1

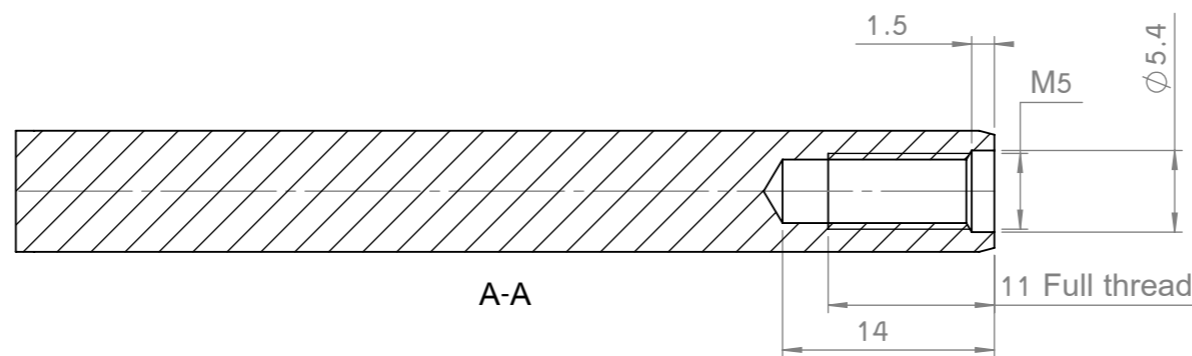

Approved For Production
21/04/2016

UNLESS OTHERWISE SPECIFIED

DIMENSIONS ARE IN MM		DO NOT SCALE DWG	
MACHINING REQUIREMENTS			
- BREAK SHARP CORNERS AND EDGES 0.1-0.2.		GENERAL TOLERANCES:	
- INTERNAL CORNERS OF CUTOUT R0.1-R0.2.		0-30: ± 0.2	HOLES 0-20: $+0.1$
- C'SINK INTERNAL THREAD 90° TO MAJOR DIA.		30-500: ± 0.3	BETWEEN HOLES: ± 0.1
- CHAMFER EXTERNAL THREAD 45° TO MINOR DIA.		500-1000: ± 0.5	ANGLES: $\pm 0.5^\circ$
- CORNER RADIUS 0.2 MIN		1000+: ± 1	SCALE: 2:1

	NAME	DATE	
DESIGNED	Adam.C-SW	04/02/2015	
DRAWN	Yoav.S-SW	01/12/2015	HUB PIN
CHECKED	Abraham.L-SW	01/04/2016	
MATERIAL:	SEE NOTES		ASSY NO. Sheet 1 of 1 DRAW NO. REVISION SW-02-1103 20
FINISH:	SEE NOTES		